

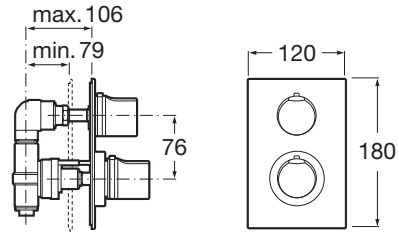

MOAI

Built-in thermostatic bath-shower mixer with diverter-flow regulator

TECHNICAL DRAWINGS



FEATURES

- Application place: Bathtub, Shower
- Diverter-flow regulator
- Faucet type: Thermostatic
- Finish: Chrome
- Inferior free outlet
- Installation type: Built-in
- NumberOfWaterInlets: 2
- Sustainable product
- Temperature selection
- Water connection thread: 1/2" - 1/2"



Evershine



Quick reaction ©



SafeTouch ©



Security 38° ©

## Moai

Stylised, pure and elegant forms add a touch of distinction and class to each space. With this series, every piece is conceived to achieve maximum functionality, facilitating every user's daily tasks. Strength, versatility and convenience are the main attributes of these high quality and easy-to-handle pieces.



### INSTALLATION AND USER MANUALS



[Installation Handbook](#)



[Exploded view](#)